

PALACE

RESIDENCES
CREEK BLUE

EMAAR

Elegance
Beyond
the Horizon





LOCATION

Dubai Creek Harbour

An ultra-modern, stylish, and pedestrian friendly neighbourhood that integrates with Dubai's sustainable urban character.

Situated along the historic Dubai Creek, Dubai Creek Harbour consists of 7.4 million sqm of residential space and 500,000 sqm of parks & open spaces with a viable mix of retail, business, recreation, and community facilities, all within walking distance.

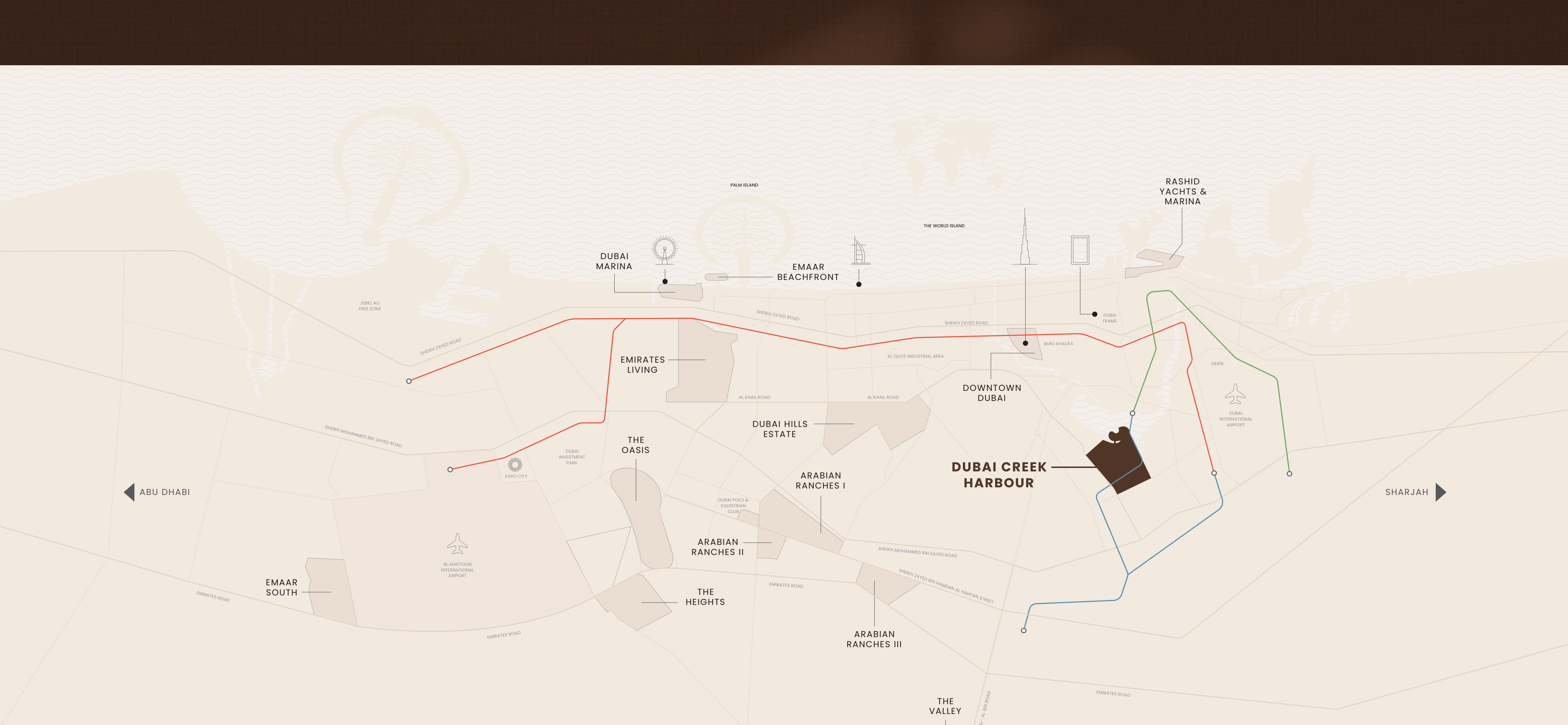

Conveniently Located

10 Mins
from Downtown Dubai

15 Mins
from Dubai International Airport

40 Mins
from Al Maktoum International Airport

DUBAI METRO LINES
RED LINE
GREEN LINE
FUTURE BLUE LINE

Close to Everything, Far from Ordinary

Palace Residences Creek Blue is nestled in a special district near Creek Beach, ideal for those looking for an active way of life.

Explore the scenic waterfront promenade, enjoy play areas and an adventure playground, and go on thrilling adventures at the cycling track and skate park. Sports courts await your competitive spirit, and connections to the RTA ferry terminal and metro station promise seamless mobility.





RESIDENCES

Living in Palace Residences Creek Blue

Welcome to Palace Residences Creek Blue, a haven of sophistication and style in the heart of one of Dubai's most desirable neighbourhoods.

Offering breathtaking views and thoughtful architectural style, every detail has been meticulously crafted to provide you with not only a home, but also a lifestyle in the true signature of the prestigious Palace Hotels and Resorts brand.

A Modern Oasis of Urban Charm



Unmatched Views

The breathtaking views are undoubtedly one of Palace Residences Creek Blue's best features. Whether overlooking the serene waters of Dubai Creek or the lush greenery of Central Park, each apartment offers panoramic views that stretch across the skyline, ensuring a visual feast from every angle.

The tower's strategic location ensures unobstructed views, making every home a viewing platform for the beauty of Dubai Creek Harbour.



Your Window to Splendid Vistas





INTERIORS

Luxury Living Redefined

Experience unparalleled comfort in our meticulously designed apartments.

Our residences range from elegant 1, 2 and 3-bedroom apartments, each crafted to provide a perfect blend of stylish interiors and expansive outdoor spaces, ensuring a seamless indoor-outdoor living experience.



PALACE
RESIDENCES
CREEK BLUE



Unparalleled Comfort, Unmatched Style

Immerse yourself in the refined elegance of Palace Residences Creek Blue. Each apartment is a masterpiece of modern design, with high-quality finishes and expansive windows that bathe your home in natural light.

Contemporary kitchens, luxurious bathrooms, and spacious living areas flow seamlessly to private balconies, offering stunning views and creating a perfect private retreat.



Everything You Need,
Right Here.





AMENITIES

Exceptional Lifestyle

At Palace Residences Creek Blue, luxury extends beyond your front door. Enjoy secure parking, a glass-enclosed fitness pavilion with pool views, and a beautifully landscaped podium with direct access to the waterfront promenade offering a seamless connection to vibrant waterfront living.

Glass Pavilion Gym with Pool Views

Multipurpose & Games Room

Adults' & Kids' Pools

BBQ Areas

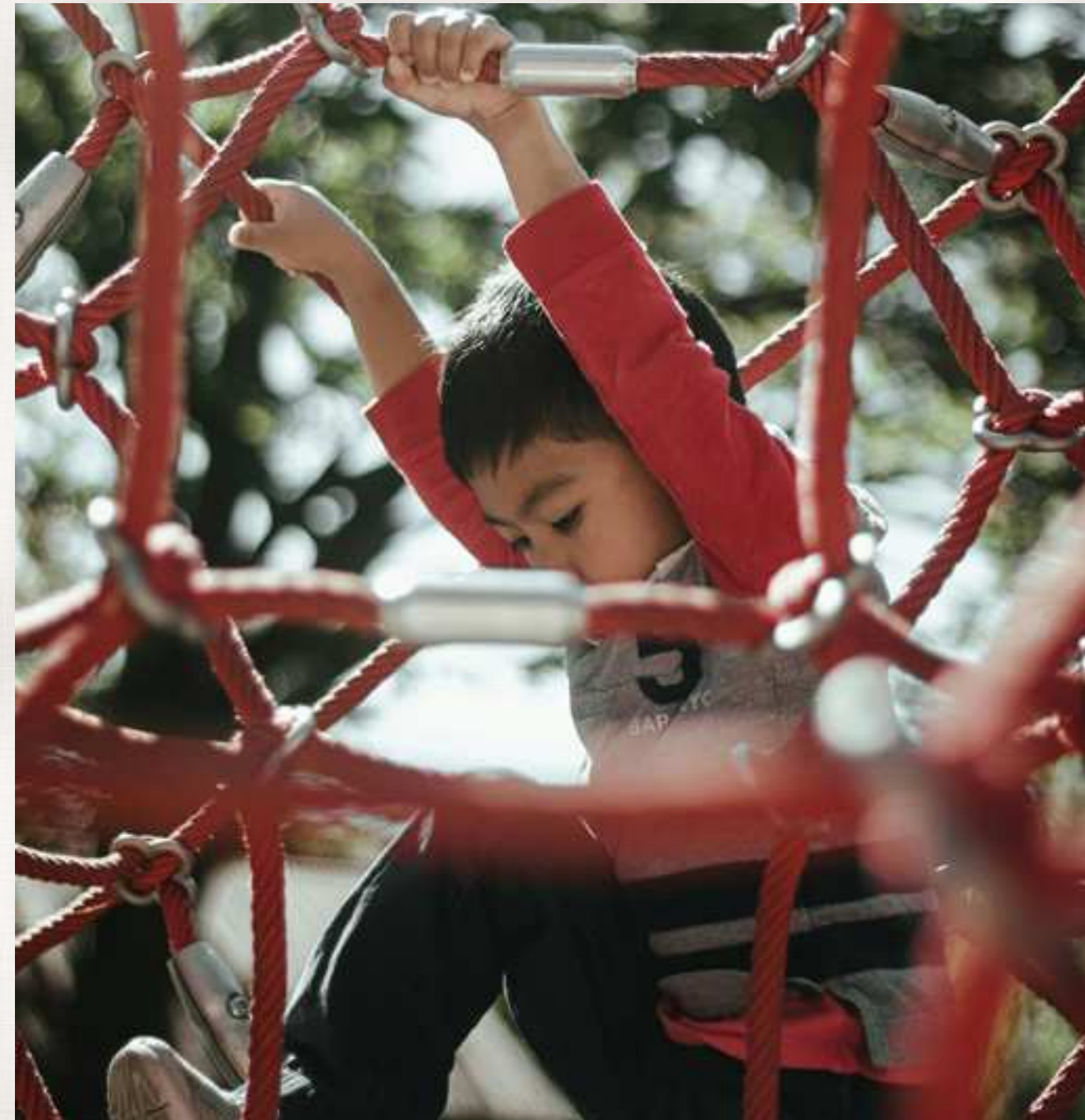

PALACE

HOTELS AND RESORTS

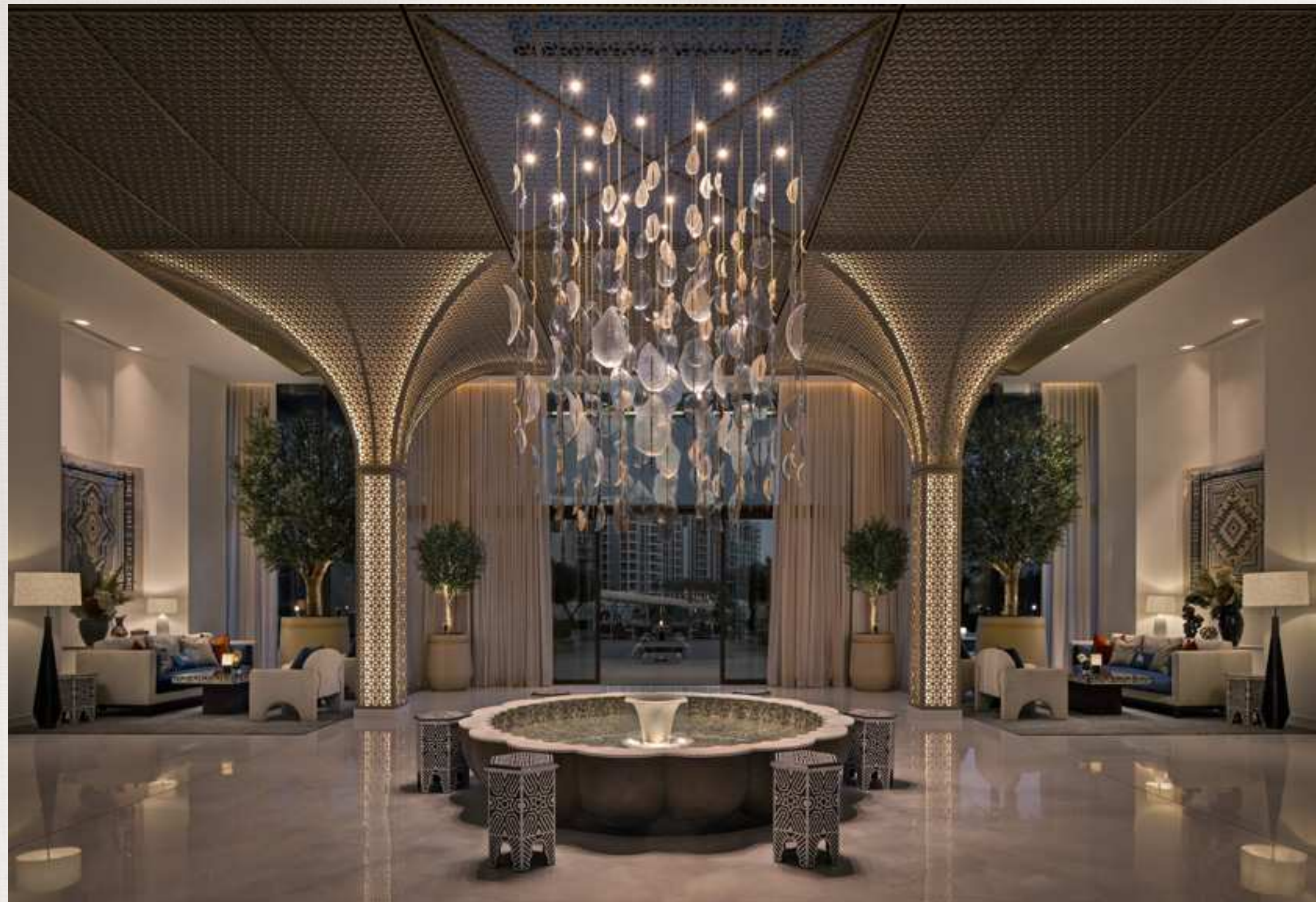

At the Heart of it All

As a distinguished member of the Address Hotels + Resorts portfolio, the Palace Hotels + Resorts is celebrated for setting the benchmark in luxury and meticulous craftsmanship. Staying at Palace transcends typical hospitality, offering a unique approach to refinement with personalised services and meticulous attention to detail. An experience that is truly a continuation of your desired lifestyle where you can be at the heart of it all.

A woman is shown in profile, facing right, wearing a dark, form-fitting top and a long, sheer, flowing skirt or dress. The fabric of the skirt is translucent and catches the light, creating soft, ethereal patterns. The background is a warm, golden glow, suggesting a sunset or sunrise. The overall mood is elegant and sophisticated.

A Haven of
Style & Elegance



NEARBY ATTRACTIONS

Central Park

The heart of island living, Dubai Creek Harbour's Central Park offers residents a tranquil refuge to unwind, first-class amenities to enjoy, and wide-open spaces to discover. With a total area of six football fields, Dubai's Central Park is one of the largest parks in the emirate and offers a variety of activities for the whole family.

Kids Play Area

Skating Areas

Lawn Amphitheatre

Splash Pad Fitness Plaza

Dog Park

NEARBY ATTRACTIONS

Creek Island

The Island District is a waterfront development that mixes upscale residences with enticing leisure and recreational amenities to create a world-class waterfront community. The district's green central park, stunning marina, yacht club, and five-star hotels will all be popular destinations for residents to enjoy the district's breath-taking views and memorable experiences.

Breath-taking Sunset Views

Licensed Bars & Restaurants

Dining at the Promenade

Upscale Hotels





NEARBY ATTRACTIONS

Creek Marina

With a wide variety of retail, dining, and recreational options, Creek Marina never slows down. Landscaped pedestrian walkways offer stunning views of Downtown Dubai at dusk, while world-class art pieces add another layer to the trendsetting lifestyle.

Vida Creek Harbour Hotel

Yacht Club Marina with 81 Berths

Sculptural Viewing Deck

Food Trucks

Art Installations

EMAAR

Global Lifestyle Developer

A leader in the global real estate market, EMAAR has grown over the years to become the largest real estate developer outside of China. You will be investing with one of the best-regarded brands in the world*.

AED 70.09 Bn
Market Cap - FY 2023

AED 26.7 Bn
Revenue - FY 2023

AED 11.6 Bn
Net Profit - FY 2023

12+
Global Market Presence

108,000
Residential Units Delivered

25,500+
Residential Units Currently
Under Development

*As on 31 December 2023



PALACE

RESIDENCES
CREEK BLUE

FOR MORE INFORMATION

Please call 800 36227 (UAE) / +971 4 366 1688 (International)
or talk to our Property Advisor directly at +971 4888 8844 from 9 AM to 7 PM (GST), Monday to Friday.

Visit our online sales centre at emaar.com or any of our Sales Centres across the UAE.

DUBAI

Emaar Sales Centre | Next to Souq Al Bahar, Downtown Dubai

9:30 AM to 10 PM, Sunday - Friday

9:30 AM to 7 PM, Saturday

Dubai Hills Estate Sales Pavilion | Umm Suqeim Road

Dubai Creek Harbour Sales Pavilion | Ras Al Khor

From 9:30 AM to 7 PM, Sunday - Saturday

ABU DHABI

Emaar Sales Centre | Al Nahda Tower, Ground Floor, 4th Street, Corniche, Al Muroor Road

From 9:30 AM to 7 PM, Sunday - Friday

EMAAR