

# avena

THE VALLEY



EMAAR

# Find Your Adventure



## In Harmony with Nature

The Valley is a quaint new town consisting of modern townhouse complexes where life finds its inspiration amidst the vast shimmering sands and lush green open spaces.

Discover new facets of The Valley, where beautifully landscaped urban gardens invite you to immerse yourself in nature and live the active lifestyle you've always dreamed of.



# Welcome to Your Dream Haven



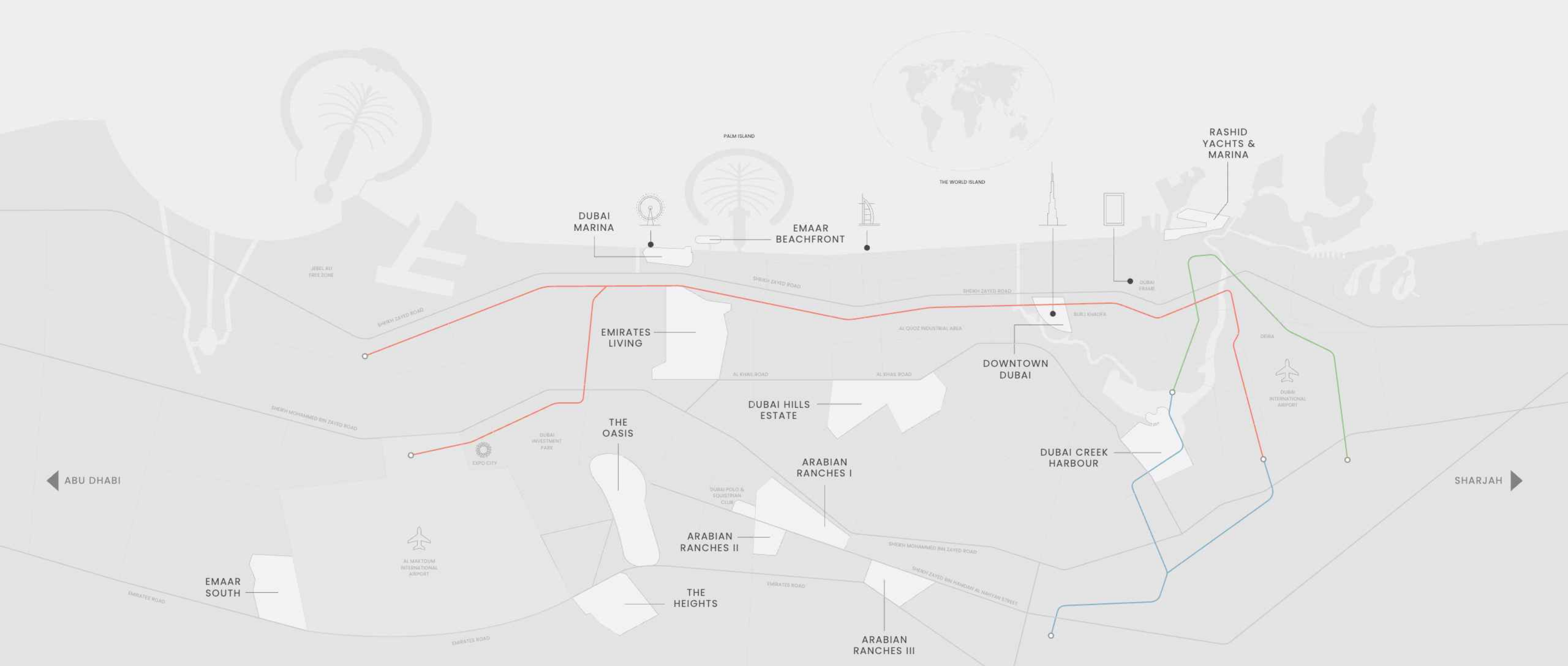

# Rooted and Connected

**05**  
Minutes' Drive to  
Rugby Sevens Stadium

**12**  
Minutes' Drive to  
Dubai Outlet Mall

**25**  
Minutes' Drive to  
Burj Khalifa and Dubai Mall

**25**  
Minutes' Drive to  
Dubai Int' Airport

**DUBAI METRO LINES**

- RED LINE
- GREEN LINE
- FUTURE BLUE LINE



# Embracing the Outdoors in Harmony with Nature



Discover Avena in The Valley's newly launched second phase, where contemporary elegance meets the gentle embrace of nature. This enchanting community of ~4-bedroom villas is thoughtfully designed to offer a lifestyle of harmony and sustainability.



## Your Gateway to Tranquility

Discover Avena in The Valley's newly launched second phase, where contemporary elegance meets the gentle embrace of nature. This enchanting community of 4-bedroom villas is thoughtfully designed to offer a lifestyle of harmony and sustainability.



Embracing  
Nature's Touch





## Balanced Lifestyle

Living at Avena means finding balance and forging connections. Stroll through lush landscapes, embark on outdoor adventures, and create lasting bonds with your neighbours. Here, every day offers a blend of relaxation and excitement.



Experience  
Opulence Every Day



# Modern Sophistication

Avena's architecture celebrates modern simplicity and elegance. With three unique façade styles, these villas bring a diverse yet harmonious beauty to the community, offering a timeless appeal.



Designed  
for Togetherness



# Elevated Style in Every Corner



Step inside Avena's homes and be greeted by interiors that radiate warmth and style. Natural warm tones create inviting spaces, ensuring your home is a sanctuary of comfort and elegance.



Embrace the  
Warmth of Home



## Space, Comfort and Luxury

Our villas, each boasting four bedrooms, are designed with families in mind. Spacious and luxurious, these homes provide the perfect combination of comfort and practicality for modern living.







## Nearby Amenities: The Valley's New Facets

Explore the latest additions to The Valley, where beautifully landscaped gardens and vibrant spaces invite you to immerse yourself in nature. Welcome to a community that blends elegance with the great outdoors.

## Dunescape

Experience the serene beauty of rolling sands that create a peaceful retreat. Walking through this natural landscape promotes relaxation and creativity, offering a welcome break from everyday life.

## Forest Walk

Explore lush greenery along a winding path that immerses you in nature's raw beauty, fostering a sense of freedom and inspiration. The diverse forest landscape offers a unique aesthetic experience that deepens your connection to nature.

## Meadow Walk

Stroll through open, sunlit spaces perfect for relaxation and play. These inviting meadows spark creativity and fresh ideas. The interplay of light, shadow, and colour creates a dynamic environment for all ages to enjoy.



## Nature-themed Play

Let your imagination soar in areas that foster adventurous and imaginative play. Climb, explore, and interact with nature in a setting that encourages creativity and curiosity.

## Sensory Play

Engage your senses in imaginative spaces designed to stimulate and delight. With a variety of textures, smells, and sounds, these areas encourage both children and adults to explore the wonders of nature.

## Flower Farm

Discover the vibrant beauty of colourful blooms and fragrant scents. This lush floral landscape offers a tranquil escape and a feast for the senses, perfect for leisurely walks and peaceful moments.

# Shallow River

Unwind and Enjoy the Soothing Sounds  
and Sights of Flowing Water



# Skate-Park

Feel the Thrill  
In A Lively Space

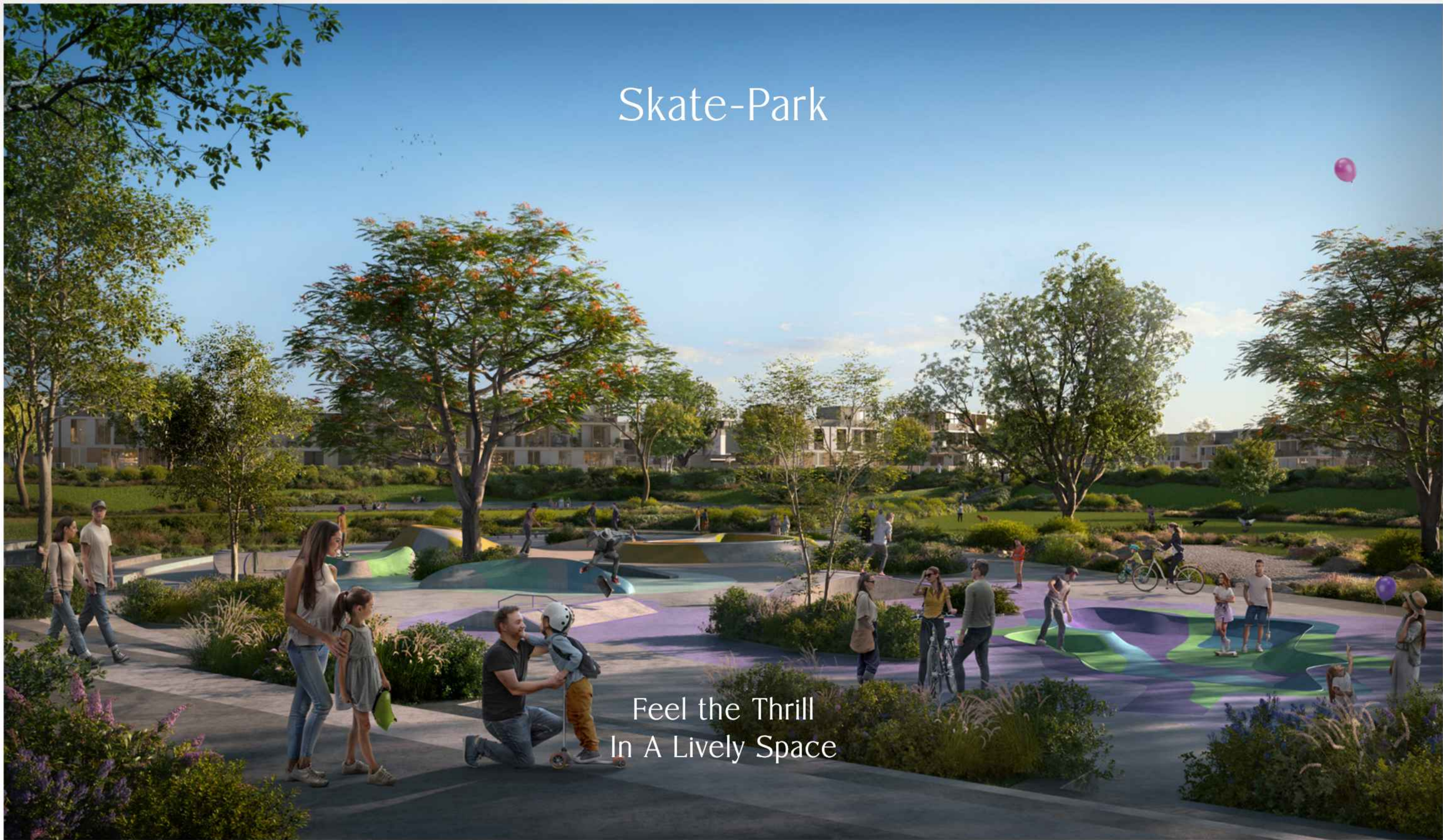

# Resort-Styled Community Centre





# Adventure Play

Dynamic and Challenging Play Opportunities  
to Inspire Physical Activity









# EMAAR

## Global Lifestyle Developer

A leader in the global real estate market, EMAAR has grown over the years to become the largest real estate developer outside of China. You will be investing with one of the best-regarded brands in the world\*.

70.09 Bn AED  
Market Cap - FY 2023

26.7 Bn AED  
Revenue - FY 2023

108,000  
Residential Units Delivered

12+  
Global Market Presence

11.6 Bn AED  
Net Profit - FY 2023

25,500+  
Residential Units Under Development

\*As on 31 December 2023

# avena

THE VALLEY

For more information please call 800 36227 (UAE) / +971 4 366 1688 (International)  
or talk to our Property Advisor directly at +971 4888 8844 from 9 AM to 7 PM (GST),  
Monday to Friday.

Visit our online sales centre at [emaar.com](http://emaar.com) or any of our Sales Centres across the UAE.

## DUBAI

Emaar Sales Centre | Next to Souq Al Bahar, Downtown Dubai

9:30 AM to 10 PM, Sunday - Friday

9:30 AM to 7 PM, Saturday

Dubai Hills Estate Sales Pavilion | Umm Suqeim Road

Dubai Creek Harbour Sales Pavilion | Ras Al Khor

From 9:30 AM to 7 PM, Sunday - Saturday

## ABU DHABI

Emaar Sales Centre | Al Nahda Tower, Ground Floor, 4th Street, Corniche,

Al Muroor Road

From 9:30 AM to 7 PM, Sunday - Friday

# EMAAR



# THE VALLEY

Phase Two



*The Vision*

A haven where  
an adventure awaits  
you at every corner

*Introducing*



T H E V A L L E Y

Phase Two

Central Park

*Explore the Winding Pathways*  
Inspired By Nature



Hills



Meadows



Forest



River



Valley

Hills

Forest

Meadows

River

Valley



THE VALLEY  
PHASE TWO  
CENTRAL PARK

*Find Your  
Adventure*



# Get the Explorer in you free

- 1 - PARK ENTRY WITH FEATURE SHADE STRUCTURE
- 2 - FITNESS PLAY AREA
- 3 - JUNIOR SOCCER PITCH
- 4 - TENNIS AND BASKETBALL COURTS
- 5 - PADEL TENNIS COURT
- 6 - SCULPTURAL LANDFORM WALK
- 7 - ORCHARD / FRUIT TREE GROVE
- 8 - FLOWER FARM
- 9 - YOGA/MEDITATION AREA
- 10 - COMMUNITY GHAF TREE NURSERY
- 11 - SUNKEN RECREATION LAWN - STORMWATER POND
- 12 - ADVENTURE PLAY AREA
- 13 - MEANDERING RIVER
- 14 - FOUNTAIN AND LOOK-OUT POINT
- 15 - RIVERSIDE SUNKEN SEATING LOUNGE
- 16 - RIVERSIDE PALM GROVE-SEATING PLAZA
- 18 - CALISTHENICS AND PARKOUR FITNESS AREA
- 19 - SKATEPARK AND SCOOTER PUMP TRACK
- 20 - HALF BASKETBALL COURT AND TABLE TENNIS
- 21 - AMPHITHEATRE AT SUNKEN EVENTS LAWN-STORMWATER POND
- 22 - DOG PARK
- 23 - DECKED OVERLOOK PLATFORM
- 24 - VALLEY TRAILS - ROCKS, GRAVEL AND NATIVE PLANTING
- 25 - NATURE THEMED-PLAY AREA
- 26 - PRIMARY PATH AND JOGGING ROUTE / VALLEY CROSSING POINT
- 27 - STEPPED DECK ACCESS TO VALLEY TRAILS
- 28 - SEATING PLAZA AT SUNKEN LAWN - STORMWATER POND
- 29 - UNDULATING MEADOW
- 30 - LAKESIDE PAVILION AND DECKED LOOK-OUT POINT
- 31 - LAKE AND MEANDERING STREAM
- 32 - TOPOGRAPHIC PLAY AREA
- 33 - FITNESS, GAMES AND HAMMOCK AREA



*Discover*  
Hidden Gems



Dunescapes



Forest Walk



Shallow River



Nature-Themed Play



Meadow Walkway



Flower Farm



Adventure Play



River Crossing



Skate Park



Sensory Play

*Live Actively*  
Live Dynamically







*Spaces That*  
Connect with Nature













*Communities that*  
Coexist with Nature







# THE VALLEY

Phase Two